

Greater China Distributer:

Guangzhou Renxin Mechanical&Electronic Equipment Co.,Ltd

ASAHI AV VALVE AND PIPING SYSTEMS

ASAHI AV VALVES

The specifications in this brochure are subject to change without prior notice due to improvements and modifications.

ASAHI AV VALVES

AURO HISTORY	2	BUTTERFLY VALVE TYPE 56	30
INDEX	3	BUTTERFLY VALVE TYPE 75	31
TYPES OF ASAHI AV PRODUCTS	4 - 5	BUTTERFLY VALVE TYPE 57L (LUG STYLE)	32 - 33
RANGE OF NOMINAL SIZE AND MATERIALS	6 - 7	BUTTERFLY VALVE TYPE 55	34 - 35
DIAPHRAGM VALVE TYPE 14	8 - 9	PDCPD BUTTERFLY VALVE	36 - 37
TRUE UNION DIAPHRAGM VALVE TYPE 14	10 - 11	ROTARY DAMPER	38 - 41
DIAPHRAGM VALVE TYPE 15	12 - 13	SWING CHECK VALVE	42 - 43
DIAPHRAGM VALVE TYPE 72	14 - 16	BALL CHECK & BALL FOOT VALVE	44 - 47
BALL VALVE TYPE 21	17 - 19	Y-SEDIMENT STRAINER	48 - 49
3-WAY BALL VALVE TYPE 23	20 - 21	DIAPHRAGM VALVE TYPE 14 PNEUMATIC	50
3-WAY BALL VALVE TYPE 23H	22 - 23	TU DIAPHRAGM VALVE TYPE 14 PNEUMATIC	51
COMPACT BALL VALVE	24	AV GASKET	52 - 53
LAB COCK	25 - 26	NOTES	54
PANEL MOUNTING	27	ABBREVIATIONS	55
BUTTERFLY VALVE TYPE 57	28 - 29	LOCATIONS	56

Tell: +86)020-82228060 Fax: +86)020-82226718
 Contact: : Dennis Ding/丁劲嵩 +86)13922707985
 Web: www.ren-xin.com Email: sales@ren-xin.com



Asahi AV Products

Make Your Systems More Sophisticated.



DIAPHRAGM VALVE
TYPE14
(Page 8 - 9)



TRUE UNION
DIAPHRAGM VALVE TYPE14
(Page 10 - 11)



DIAPHRAGM VALVE
TYPE15
(Page 12 - 13)



DIAPHRAGM VALVE
TYPE72
(Page 14 - 16)



LAB COCK
(Page 25 - 26)



BUTTERFLY VALVE
TYPE57
(Page 28 - 29)



BUTTERFLY VALVE
TYPE56
(Page 30)



BUTTERFLY VALVE
TYPE75
(Page 31)

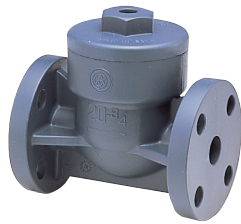

SWING CHECK VALVE
(Page 42 - 43)



BALL CHECK AND
BALL FOOT VALVE
(Page 44 - 47)



Y-SEDIMENT STRAINER
(Page 48 - 49)

Tell: +86)020-82228060 Fax: +86)020-82226718
Contact: : Dennis Ding/丁劲嵩 +86)13922707985
Web: www.ren-xin.com Email: sales@ren-xin.com

To meet your specific requirements, Asahi AV Valves are made of wide variety of materials and are available in various types and sizes.

You are surely making the best choice for your systems when selecting Asahi AV products.



**BALL VALVE
TYPE21**
(Page 17 - 19)



**3-WAY BALL VALVE
TYPE23**
(Page 20 - 21)



**3-WAY BALL VALVE
TYPE23H**
(Page 22 - 23)



COMPACT BALL VALVE
(Page 24)



**BUTTERFLY VALVE
TYPE57L(LUG STYLE)**
(Page 32 - 33)



**BUTTERFLY VALVE
TYPE55**
(Page 34 - 35)



PDCPD BUTTERFLY VALVE
(Page 36 - 37)



ROTARY DAMPER
(Page 38 - 41)



**DIAPHRAGM VALVE TYPE 14,
PNEUMATIC ACTUATED MODEL**
(Page 50)



**T.U. DIAPHRAGM VALVE TYPE 14,
PNEUMATIC ACTUATED MODEL**
(Page 51)



AV GASKET
(Page 52-53)

Tell: +86)020-82228060 Fax: +86)020-82226718
 Contact:: Dennis Ding/丁劲嵩 +86)13922707985
 Web: www.ren-xin.com Email: sales@ren-xin.com

BALL VALVE TYPE 21 15mm - 100mm(1/2inch - 4inch)



NSF Product

NSF("NSF/ANSI STANDARD 61" Drinking Water System Components-Health Effects)Product.

:BALL VALVE TYPE 21(Material:PVC+EPDM,FKM)

*Certified products bear an NSF Certification Mark.

FEATURES

Easy to Be Automated (No Modification Required)

Featuring a new integral molded top flange. The BALL VALVE TYPE 21 can easily be converted from the manual to automatic without replacing the body.

Simple Installation on Panel Piping

New bottom stand with an insert hole allows the valve to be secured on bench or panel only by inserting a metallic insert.

Double-O-ring

The stem uses a double-O-ring, sealing arrangement improving durability sealing performance. The upper O-ring groove is deeper than the lower O-ring groove. Because of this design, the stem would break first at the upper O-ring groove, acting as a back up seal.

Multi Functional Handle

Removing the handle and placing the raised lugs into the carrier allow for easy disassembly of the valve.

*The handle has other colors, (blue, white, yellow)

Locking Device (Option)

The handle lock can be done by full-open (close)



MATERIAL AND WORKING TEMPERATURE

Body Material	Working Temperature °C (°F)	Max.Working Pressure(at R.T.) MPa[kgf/cm²][PSI]	End Connectors			
			Socket End	Threaded End	Flanged End	Spigot End
Unplasticized Polyvinyl Chloride(PVC)	0 - 50(30 - 120)	1.0{10.2} [150]	○	○	○	—
Chlorinated Polyvinyl Chloride(C-PVC)	0 - 90(30 - 195)	1.0{10.2} [150]	○	○	○	—
Polypropylene(PP)	-20 - 80(-5 - 175)	1.0{10.2} [150]	○	○	○	○
Polyvinylidene Fluoride(PVDF)	-20 - 100(-5 - 210)	1.0{10.2} [150]	○	○	○	○

※ PP and PVDF ball valves of the Socket End type and PVDF ball valves of the Spigot End type are welded valves.

Notes : 1. There is a dead space in a ball valve. Volatile liquids, such as a hydrogen peroxide(H₂O₂)and Sodium hypochlorite (NaClO) may vaporize in the dead space, thus causing an abnormal pressure increase in the valve.

(Important: Gas is compressible. Thus if pressure rises abnormally, the valve can burst ejecting dangerous fragments.)

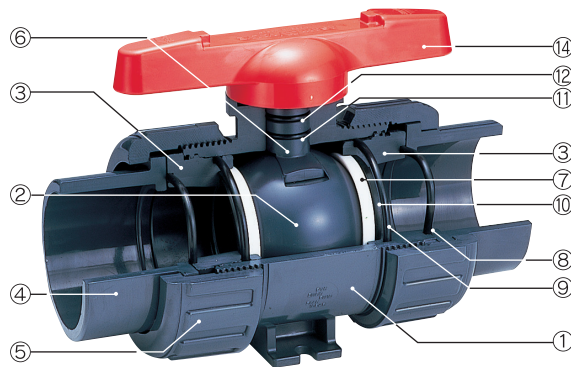
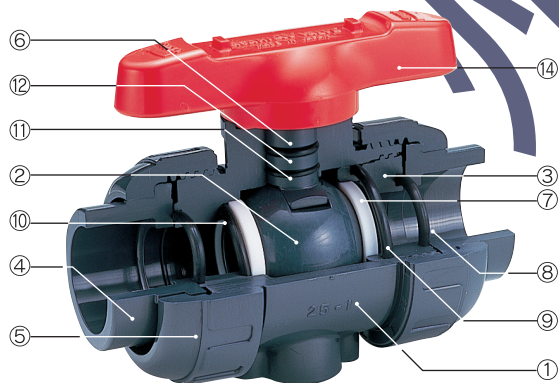

PARTS & MATERIALS

● 15mm(1/2inch) - 50mm(2inch)

No.	DESCRIPTION	Pcs.	MATERIAL	No.	DESCRIPTION	Pcs.	MATERIAL
①	BODY	1	PVC, C-PVC, PP, PVDF	⑨	O-RING(B)	1	EPDM, FKM, etc
②	BALL	1	PVC, C-PVC, PP, PVDF	⑩	O-RING(C)	2	EPDM, FKM, etc
③	CARRIER	1	PVC, C-PVC, PP, PVDF	⑪	O-RING(D)	1	EPDM, FKM, etc
④	END CONNECTOR	2	PVC, C-PVC, PP, PVDF	⑫	O-RING(E)	1	EPDM, FKM, etc
⑤	UNION NUT	2	PVC, C-PVC, PP, PVDF	⑬	STOP RING	2	PVDF(used for flanged End)
⑥	STEM	1	PVC, C-PVC, PP, PVDF	⑭	HANDLE	1	ABS
⑦	SEAT	2	PTFE				
⑧	O-RING(A)	2	EPDM, FKM, etc				

● 65mm(2 1/2inch) - 100mm(4inch)

No.	DESCRIPTION	Pcs.	MATERIAL	No.	DESCRIPTION	Pcs.	MATERIAL
①	BODY	1	PVC, C-PVC, PP, PVDF	⑨	O-RING(B)	2	EPDM, FKM, etc
②	BALL	1	PVC, C-PVC, PP, PVDF	⑩	CUSHION	2	EPDM, FKM, etc
③	CARRIER	2	PVC, C-PVC, PP, PVDF	⑪	O-RING(D)	1	EPDM, FKM, etc
④	END CONNECTOR	2	PVC, C-PVC, PP, PVDF	⑫	O-RING(E)	1	EPDM, FKM, etc
⑤	UNION NUT	2	PVC, C-PVC, PP, PVDF	⑬	STOP RING	2	PVDF(used for flanged End)
⑥	STEM	1	PVC, C-PVC, PP, PVDF	⑭	HANDLE	1	ABS
⑦	SEAT	2	PTFE	⑮	SCREW	1	STAINLESS STEEL(304)
⑧	O-RING(A)	2	EPDM, FKM, etc				

WORKING PRESSURE VS. TEMPERATURE

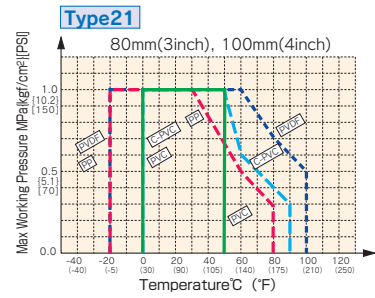
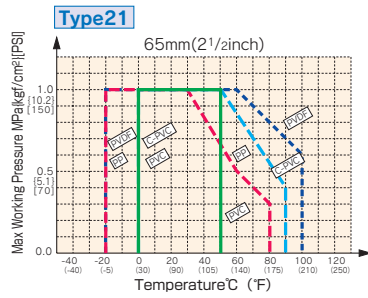
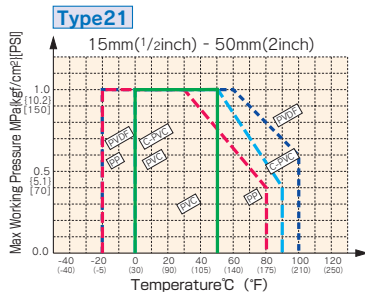

DIMENSION

● 15mm(1/2inch) - 50mm(2inch) Flanged End

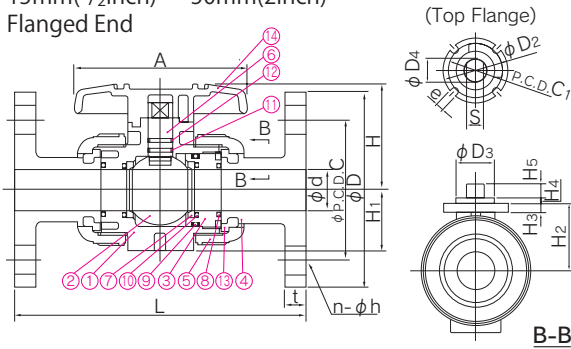

● 65mm(2 1/2 inch) - 100mm(4inch) Flanged End

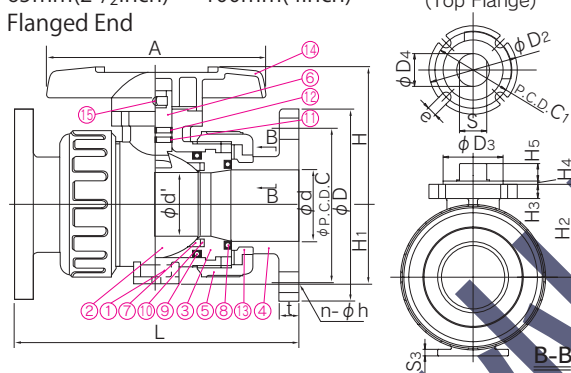

DIMENSIONS TABLE

DIN		Unit:mm																		
Nominal Size	d	d'	D ₁	D ₂	D ₃	D ₄	C ₁	H	H ₁	H ₂	H ₃	H ₄	H ₅	A	S	S ₁	S ₂	S ₃	e	
10	3/8	13	—	46	—	—	—	—	43.5	—	—	—	—	80	—	—	—	—	—	
15	1/2	15	—	48	42	25	135	36	51.5	29	30	6	3	8	105	19	7.3	11	5.5	
20	3/4	20	—	60	42	25	15	36	59.5	35	36.5	6	3	10	11	19	7.3	11	5.5	
25	1	25	—	70	42	25	15	36	68	39	43.5	6	3	10	11	19	7.3	11	5.5	
32	1 1/4	32	—	82	48	30	19	42	80.5	47	52.5	8	3	10	15	30	9	15	5.5	
40	1 1/2	40	—	100	57	35	23	50	89	55	61	10	3	12	18	30	9	15	6.5	
50	2	51	—	126	57	35	23	50	102.5	66	72.5	10	3	12	18	30	9	15	6.5	
65	2 1/2	65	58	133	81	55	30	70	126	72	85	13	3	16	24	48	9	6	9	
80	3	78	68.5	152	81	55	30	70	140	85	94	13	3	19	24	55	11	7	9	
100	4	100	90	210	116	70	40	102	178	110	126	16	3	23	34	65	11	8	11	

Nominal Size	Flanged End										Socket End						Threaded End						Spigot End								
	DIN PN10										PVC, C-PVC			PP, PVDF			PVC			PP, PVDF			PVC			PP, PVDF					
	D	C	n	h	PVC C/PVC	PP	PVDF	t	d ₁	ℓ	L	d ₁	d _{1'}	ℓ	L	d ₂	ℓ	PVC C/PVC	PP	PVDF	d ₃	d _{3'}	ℓ	d ₃	ℓ	t	L				
10	3/8	90	60	4	14	120	119	119	12	16	14	99	15.4	15.4	13	96	96	Rp3/8	15	99	98	98	16	13	16	—	—	—	—	114	114
15	1/2	95	65	4	14	130	130	130	12	20	16	102	19.5	19.3	14.5	99	99	Rp1/2	15	102	100	100	20	15	18.5	20	18.5	2.5	1.9	124	124
20	3/4	105	75	4	14	150	150	150	14	25	19	120	24.5	24.3	16	113	113	Rp3/4	17	120	119	119	25	20	24	25	22	2.7	1.9	144	144
25	1	115	85	4	14	160	160	160	14	32	22	131	31.5	31.3	18	123	123	Rp1	20	131	130	130	32	25	24.5	32	22.5	3.0	2.4	154	154
32	1 1/4	140	100	4	18	180	180	180	16	40	26	150	39.45	39.2	20.5	139	139	Rp1 1/4	22	150	146	146	40	31	28	40	26	3.7	2.4	174	174
40	1 1/2	150	110	4	18	200	200	200	16	50	31	163	49.45	49.2	23.5	149	149	Rp1 1/2	25	163	160	160	50	40	34	50	32	4.6	3.0	194	194
50	2	165	125	4	18	230	230	230	16	63	38	197	62.5	62.1	27.5	176	176	Rp2	28	197	194	194	63	51	38	63	36	5.8	3.0	224	224
65	2 1/2	185	145	4	18	290	288	287	18	75	44	233	74.25	73.95	31	205	204	Rp2 1/2	32	215	213	212	75	65	44	75	38	6.9	3.6	245	244
80	3	200	160	8	18	312	311	308	21	90	51	284	89.2	88.85	35.5	252	249	Rp3	35	265	264	261	90	80	51	90	38	8.2	4.3	296	293
100	4	220	180	8	18	352	352	347	18	110	61	351	109.05	108.65	41.5	312	307	Rp4	45	340	340	335	110	93.6	46	110	44.5	10.0	5.3	355	350

ANSI																			Unit:inch	
Nominal Size	d	d'	D ₁	D ₂	D ₃	D ₄	C ₁	H	H ₁	H ₂	H ₃	H ₄	H ₅	A	S	S ₁	S ₂	S ₃	e	
inch mm																				
1/2	15	0.59	—	1.89	1.65	0.98	0.53	1.42	2.03	1.14	1.18	0.24	0.12	0.31	3.62	0.41	0.75	0.29	0.43	0.22
3/4	20	0.79	—	2.36	1.65	0.98	0.59	1.42	2.34	1.38	1.44	0.24	0.12	0.39	3.94	0.43	0.75	0.29	0.43	0.22
1	25	0.98	—	2.76	1.65	0.98	0.59	1.42	2.68	1.54	1.71	0.24	0.12	0.39	4.33	0.43	0.75	0.29	0.43	0.22
1 1/4	32	1.26	—	3.23	1.89	1.18	0.75	1.65	3.17	1.85	2.07	0.31	0.12	0.39	4.76	0.59	1.18	0.35	0.59	0.22
1 1/2	40	1.57	—	3.94	2.24	1.38	0.91	1.97	3.50	2.17	2.40	0.39	0.12	0.47	5.16	0.71	1.18	0.35	0.59	0.26
2	50	2.01	—	4.96	2.24	1.38	0.91	1.97	4.04	2.60	2.85	0.39	0.12	0.47	6.26	0.71	1.18	0.35	0.59	0.26
2 1/2	65	2.56	2.28	5.24	3.19	2.17	1.18	2.76	4.96	2.83	3.35	0.51	0.12	0.63	7.87	0.94	1.89	0.35	0.24	0.35
3	80	3.07	2.70	5.98	3.19	2.17	1.18	2.76	5.51	3.35	3.70	0.51	0.12	0.75	9.45	0.94	2.17	0.43	0.28	0.35
4	100	3.94	3.54	8.27	4.57	2.76	1.57	4.02	7.01	4.33	4.96	0.63	0.12	0.91	11.81	1.34	2.56	0.43	0.31	0.43

Nominal Size	inch mm	Flanged End								Socket End (IPS)										Threaded End						
		ANSI CLASS 150				L				PVC, C-PVC						PP, PVDF				d ₂	ℓ	L				
		D	C	n	h	PVC, C-PVC	PP	PVDF	t	ASTM SCH40			L	ASTM SCH80			d ₁	ℓ	PP			PVDF	PVC, C-PVC	PP	PVDF	
1/2	15	3.50	2.38	4	0.62	5.63	5.63	5.63	0.47	—	—	—		—	0.848	0.836				0.875	4.45		0.83	0.87	4.45	4.45
3/4	20	3.88	2.75	4	0.62	6.77	6.77	6.77	0.55	—	—	—	—	1.058	1.046	1.000	5.08	1.03	1.00	5.08	5.08	3/4-14NPT	0.67	4.72	4.72	4.72
1	25	4.25	3.12	4	0.62	7.36	7.36	7.36	0.55	—	—	—	—	1.325	1.310	1.125	5.75	1.30	1.13	5.75	5.75	1-11 1/2NPT	0.79	5.16	5.16	5.16
1 1/4	32	4.62	3.50	4	0.62	7.48	7.48	7.48	0.63	—	—	—	—	1.670	1.655	1.250	6.46	1.65	1.25	6.46	6.46	1 1/4-11 1/2NPT	0.87	5.91	5.91	5.91
1 1/2	40	5.00	3.88	4	0.62	8.35	8.35	8.35	0.63	—	—	—	—	1.912	1.894	1.375	7.24	1.89	1.37	7.24	7.24	1 1/2-11 1/2NPT	0.98	6.42	6.42	6.42
2	50	6.00	4.75	4	0.75	9.21	9.21	9.21	0.63	—	—	—	—	2.387	2.369	1.500	8.23	2.36	1.50	8.23	8.23	2-11 1/2NPT	1.10	7.76	7.76	7.76
2 1/2	65	7.00	5.50	4	0.75	10.20	10.12	10.08	0.71	—	—	—	—	2.889	2.868	1.750	9.45	2.880	1.752	9.37	9.33	1 1/2-8NPT	1.26	8.46	8.39	8.35
3	80	7.50	6.00	4	0.75	12.05	12.01	11.89	0.71	—	—	—	—	3.516	3.492	1.875	11.14	3.480	1.874	11.10	10.98	3-8NPT	1.38	10.43	10.39	10.28
4	100	9.00	7.50	8	0.75	14.72	14.72	14.53	0.71	4.518	4.491	2.000	13.86	—	—	—	—	4.480	2.252	14.37	14.13	4-8NPT	1.77	14.25	14.25	14.06

Note : Pay attention that the following chemicals such as Hydrogen Peroxide (H₂O₂) and Sodium hypochlorite (NaClO) are adapted will cause the abnormal pressure rising due to their vaporization nature.



Tell: +86)020-82228060 Fax: +86)020-82226718

联络人: 丁劲嵩 13922707985

Web: www.ren-xin.com Email: sales@ren-xin.com

3-WAY BALL VALVE TYPE 23 15mm - 100mm (1/2inch - 4inch)

FEATURES

■ Compact and Economic

The 3-WAY BALL VALVES allows two flow patterns, using one valve. The valve is suitable for a pipeline which requires two ball valves and a tee. That is, the 3-WAY BALL VALVES is economic because it makes piping compact and saves space.

■ Reversible Flow Direction

The 3-WAY BALL VALVE is based on the Asahi true union ball valve design which can be installed or removed just by tightening or loosening its union nut. The 3-WAY BALL VALVES has a L-shaped fluid channel and a handle which can be rotated 360°. The arrow on top of the handle indicates the flow direction.

■ Equipped ISO Mounting Flange

The feature provides for easier mounting of actuators on valves.

■ Interchangeable with Ball Valve Type21

The face to face dimensions, as well as the connecting parts, end connectors and union nuts, are the same as the ball valve Type21.

■ Other Special Features

- Double O-ring seal on stem for an added protection.
- W-L port ball and *Cross port ball are available upon request.
- *Note: Cross port ball is available at the size of 15mm (1/2inch) up to 50mm (2inch).
- Built-in spanner wrench on the handle for valve disassembly and assembly.

■ NSF Product

NSF("NSF/ANSI STANDARD 61" Drinking Water System Components-Health Effects)Product.

:3-WAY BALL VALVE TYPE 23(Material:PVC+EPDM,FKM)

*Certified products bear an NSF Certification Mark.



DIMENSION

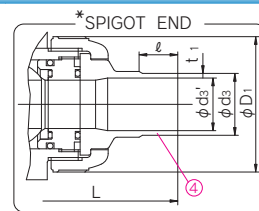
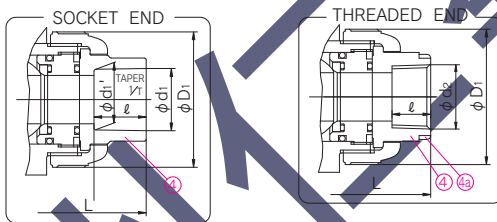
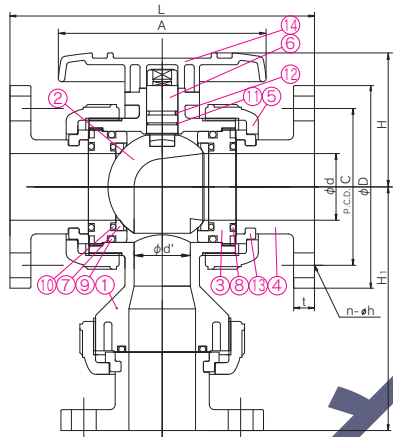

* JIS and DIN Standard only.

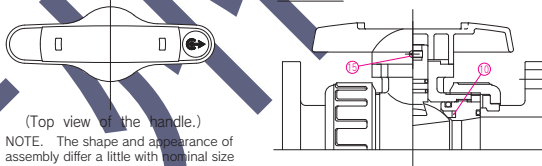

(Top view of the handle.)
NOTE: The shape and appearance of assembly differ a little with nominal size compared to this drawing.

L Port(Standard Valve)

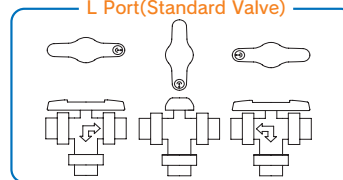

Changing the ball allows for standard valve to be converted.
(only 15mm(1/2inch)~50mm(2inch))

Double L Port(Available on Request)

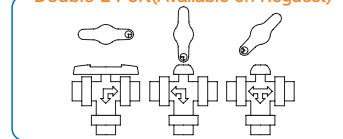

Cross Port(Available on Request)

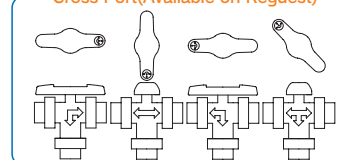

*Available at the size of 15mm up to 50mm.

MATERIAL AND WORKING TEMPERATURE

Body Material	Working Temperature °C (°F)	Max.Working Pressure(at R.T.) MPa{kgf/cm²}[PSI]	End Connectors			
			Socket End	Threaded End	Flanged End	Spigot End
Unplasticized Polyvinyl Chloride(PVC)	0 - 50(30 - 120)	1.0 {10.2} [150]	○	○	○	○
Chlorinated Polyvinyl Chloride(C-PVC)	0 - 90(30 - 195)	1.0 {10.2} [150]	○	○	○	○
Polypropylene(PP)	-20 - 80(-5 - 175)	1.0 {10.2} [150]	○ ※	○	○	○
Polyvinylidene Fluoride(PVDF)	-20 - 100(-5 - 210)	1.0 {10.2} [150]	○ ※	○	○	○

* PP and PVDF 3-WAY BALL VALVES of the Socket End are welded valves.

Note : 1. There is a dead space in a ball valve. Volatile liquids, such as a hydrogen peroxide (H₂O₂) and Sodium hypochlorite (NaClO) may vaporize in the dead space, thus causing an abnormal pressure increase in the valve. (Important: Gas is compressible. Thus if its pressure rises abnormally, the valve can burst ejecting dangerous fragments.

PARTS & MATERIALS

No.	DESCRIPTION	Pcs.	MATERIAL	No.	DESCRIPTION	Pcs.	MATERIAL
①	BODY	1	PVC,PP,C-PVC,PVDF	⑨	O-RING(B)	2	EPDM,FKM,others
②	BALL	1	PVC,PP,C-PVC,PVDF	⑩	O-RING(C), CUSHION	2	EPDM,FKM,others
③	CARRIER	2	PVC,PP,C-PVC,PVDF	⑪	O-RING(D)	1	EPDM,FKM,others
④	END CONNECTOR	3	PVC,PP,C-PVC,PVDF	⑫	O-RING(E)	1	EPDM,FKM,others
⑤	UNION NUT	3	PVC,PP,C-PVC,PVDF	⑬	STOP RING	3	PVDF(Used for Flanged End)
⑥	STEM	1	PVC,PP,C-PVC,PVDF	⑭	HANDLE	1	ABS
⑦	SEAT	2	PTFE	⑮	TAPPING SCREW(A)	1	STAINLESS STEEL304
⑧	O-RING(A)	3	EPDM,FKM,others	⑯	RING	3	STAINLESS STEEL304

Note : The stop ring (⑫) is used for Flanged End valves only.
The ring (⑯) is used for 15,20,and 25mm C-PVC valves.

WORKING PRESSURE VS. TEMPERATURE

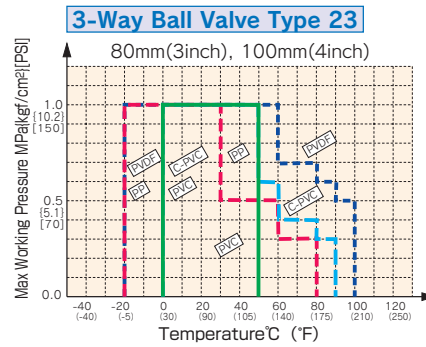
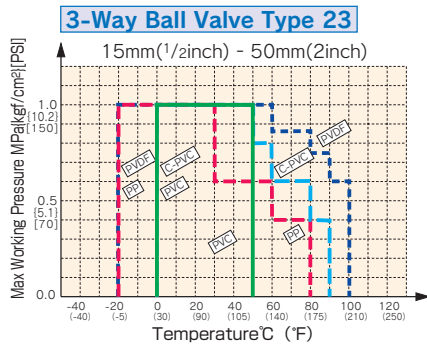

DIMENSIONS TABLE

DIN		Unit:mm																			
Nominal Size	mm inch	Flanged End							Socket End									Threaded End			
		DIN PN10				L	t	H ₁	PVC, C-PVC			PP, PVDF			d ₂	ℓ	L	H ₁			
D	C	n	h	d ₁	ℓ				L	H ₁	d ₁	d ₁ '	ℓ	L					H ₁	d ₂	ℓ
15	1/2	95	65	4	14	130	12	88	20	16	102	72	19.50	19.30	14.5	99	71	Rp 1/2	15	102	74
20	3/4	105	75	4	14	150	14	104	25	19	120	85	24.50	24.30	16	114	83	Rp 3/4	17	120	89
25	1	115	85	4	14	160	14	120	32	22	131	104	31.50	31.30	18	123	100	Rp 1	20	131	105
40	1 1/2	150	110	4	18	200	16	159	50	31	163	142	49.45	49.20	23.5	148	131	Rp 1 1/2	25	163	141
50	2	165	125	4	18	230	16	185	63	38	197	170	62.50	62.10	27.5	176	154	Rp 2	28	197	168
80	3	200	160	8	18	310	21	259	90	51	282	245	89.20	88.85	35.5	251	224	Rp 3	35	264	235
100	4	220	180	8	18	350	18	305	110	61	349	305	109.05	108.65	41.5	310	279	Rp 4	45	338	299

Nominal Size	mm inch	Spigot End																		
		PVC				PP, PVDF														
		d ₃	d ₃ '	ℓ	H ₁	d ₃	ℓ	t	L	H ₁										
							PP	PVDF												
15	1/2	20	15	18.5	83	20	18.5	2.5	1.9	124	83									
20	3/4	25	20	24	99	25	22	2.7	1.9	144	99									
25	1	32	25	24.5	115	32	22.5	3.0	2.4	154	115									
40	1 1/2	50	40	34	153	50	32	4.6	3.0	194	153									
50	2	63	51	38	178	63	36	5.8	3.0	224	178									
80	3	90	80	51	252	90	38	8.2	4.3	295	246									
100	4	110	93.6	61	308	110	44.5	10.0	5.3	353	301									

ANSI		Unit:inch																								
Nominal Size	inch mm	Flanged End							Socket End											Threaded End						
		ASTM Class 150				L	t	H ₁	PVC, C-PVC			PP, PVDF			d ₂	ℓ	L	H ₁								
		D	C	n	h				ASTM SCH40			ASTM SCH80							d ₁	ℓ	L	H ₁				
								d ₁	d ₁ '	ℓ	L	d ₁	d ₁ '	ℓ	L	H ₁	d ₁	ℓ	L	H ₁	d ₂	ℓ	L	H ₁		
1/2	15	3.50	2.38	4	0.62	5.63	0.47	3.70	—	—	—	0.848	0.836	0.875	4.45	3.08	0.830	0.870	4.45	3.09	1/2-14 NPT	0.59	4.02	2.89		
3/4	20	3.88	2.75	4	0.62	6.77	0.55	4.50	—	—	—	1.058	1.046	1.000	5.08	3.56	1.030	1.000	5.08	3.61	3/4-14 NPT	0.67	4.72	3.48		
1	25	4.25	3.12	4	0.62	7.36	0.55	5.24	—	—	—	1.325	1.310	1.125	5.75	4.32	1.300	1.130	5.75	4.37	1-11 1/2 NPT	0.79	5.16	4.13		
1 1/2	40	5.00	3.88	4	0.62	8.35	0.63	6.50	—	—	—	1.912	1.894	1.375	7.24	5.71	1.890	1.370	7.24	5.85	1 1/2-11 1/2 NPT	0.98	6.42	5.53		
2	50	6.00	4.75	4	0.75	9.21	0.63	7.34	—	—	—	2.387	2.369	1.500	8.23	6.66	2.360	1.500	8.23	6.76	2-11 1/2 NPT	1.10	7.76	6.61		
3	80	7.50	6.00	4	0.75	11.97	0.71	10.06	—	—	—	3.516	3.492	1.875	11.10	9.59	3.480	1.874	11.10	11.10	3-8 NPT	1.38	10.39	9.25		
4	100	9.00	7.50	8	0.75	14.65	0.71	12.01	4.518	4.491	2.000	13.90	—	—	—	11.58	4.480	2.252	14.37	14.37	4-8 NPT	1.77	14.17	11.77		
Nominal Size	inch mm	Flanged End								Socket End																
		d	d'	D ₁	D ₂	D ₃	D ₄	C ₁	H	Nominal Size	d	d'	D ₁	D ₂	D ₃	D ₄	C ₁	H	H ₂	H ₃	H ₄	H ₅	A	S	e	
15	1/2	15	15	48	42	25	13.5	36	51.5	30	6	3	8	92	10.5	5.5										
20	3/4	20	20	60	42	25	15	36	59.5	36.5	6	3	10	100	11	5.5										
25	1	25	25	70	42	25	15	36	68	43.5	6	3	10	110	11	5.5										
40	1 1/2	40	32	100	57	35	23	50	89	61	10	3	12	131	18	6.5										
50	2	51	43	126	57	35	23	50	102.5	72.5	10	3	12	159	18	6.5										
80	3	78	68.5	152	81	55	30	70	140	94	13	3	19	240	24	9										
100	4	100	90	210	116	70	40	102	178	126	16	3	23	300	34	11										

3-WAY BALL VALVE TYPE 23H 25mm - 40mm(1inch - 1 1/2inch)

FEATURES

- **Horizontal Model**
The 3-WAY BALL VALVE TYPE 23H is horizontal model(T port).
- **Same Features as TYPE23**
 - a) Compact and Economic
 - b) Reversible Flow Direction
 - c) Equipped ISO Mounting Flange
 - d) Interchangeable with Ball Valve Type21



DIMENSION

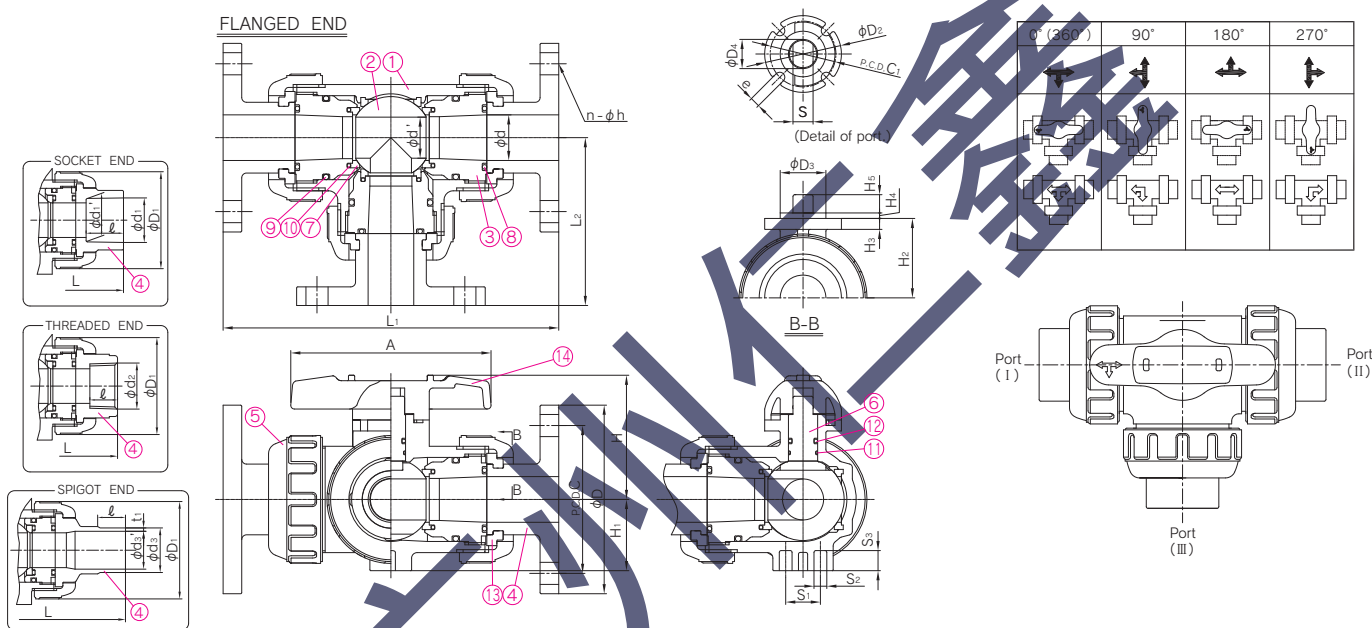

MATERIAL AND WORKING TEMPERATURE

Body Material	Working Temperature °C (°F)	Max.Working Pressure(at R.T.) MPa{kgf/cm²}[PSI]	End Connectors			
			Socket End	Threaded End	Flanged End	Spigot End
Polypropylene(PP)	-20 - 80(-5 - 175)	1.0{10.2}[150]	○ ※	○	○	○

* PP 3-WAY BALL VALVES of the Socket End are welded valves.

Note : 1. There is a dead space in a ball valve. Volatile liquids, such as a hydrogen peroxide (H₂O₂) and Sodium hypochlorite (NaClO) may vaporize in the dead space, thus causing an abnormal pressure increase in the valve. (Important: Gas is compressible. Thus if its pressure rises abnormally, the valve can burst ejecting dangerous fragments.

PARTS & MATERIALS

No.	DESCRIPTION	Pcs.	MATERIAL	No.	DESCRIPTION	Pcs.	MATERIAL
①	BODY	1	PP	⑧	O-RING(A)	3	EPDM,FKM,others
②	BALL	1	PP (T Port)	⑨	O-RING(B)	3	EPDM,FKM,others
③	CARRIER	3	PP	⑩	O-RING(C)	3	EPDM,FKM,others
④	END CONNECTOR	3	PP	⑪	O-RING(D)	1	EPDM,FKM,others
⑤	UNION NUT	3	PPG	⑫	O-RING(E)	1	EPDM,FKM,others
⑥	STEM	1	PP	⑬	STOP RING	3	PVDF(Used for Flanged End)
⑦	SEAT	4	PTFE	⑭	HANDLE	1	ABS

Tell: +86)020-82228060 Fax: +86)020-82226718

联络人: 丁劲嵩 13922707985

DIMENSIONS TABLE

DIN		Unit:mm																				
Nominal Size	mm inch	Flanged End						Socket End					Threaded End				Spigot End					
		DIN PN10				t	L ₁	L ₂	d ₁	d ₁ '	ℓ	L ₁	L ₂	d ₂	ℓ	L ₁	L ₂	d ₃	ℓ	t	L ₁	L ₂
25	1	115	85	4	14	14	189	94.5	31.5	31.3	18	152	76	Rp 1	20	159	79.5	32	22.5	3.0	183	91.5
32	1 1/4	140	100	4	16	16	260	130	39.45	39.2	20.5	197	98.5	Rp 1 1/4	22	208	104	—	—	—	—	—
40	1 1/2	150	110	4	16	16	248	124	49.45	49.2	23.5	197	98.5	Rp 1 1/2	25	208	104	50	32	4.6	242	121

Nominal Size	mm inch	d	d'	D ₁	D ₂	D ₃	D ₄	C ₁	H	H ₁	H ₂	H ₃	H ₄	H ₅	A	S	S ₁	S ₂	S ₃	e
25	1	25	22	70	42	25	15	36	68	39	43.5	6	3	10	110	11	19	7.3	11	5.5
32	1 1/4	40	34	100	57	35	23	50	89	55	61	10	3	12	131	18	30	9	15	6.5
40	1 1/2	40	34	100	57	35	23	50	89	55	61	10	3	12	131	18	30	9	15	6.5

ANSI		Unit:mm															
Nominal Size	mm inch	Flanged End						Socket End					Threaded End				
		ANSI Class150				t	L ₁	L ₂	d ₁	ℓ	L ₁	L ₂	d ₂	ℓ	L ₁	L ₂	
25	1	4.25	3.13	4	0.62	0.55	8.50	4.25	1.30	1.13	6.77	3.39	1-11 1/2NPT		0.79	6.26	3.13
32	1 1/4	4.62	3.50	4	0.62	0.63	10.24	5.12	1.65	1.25	8.74	4.37	1 1/4-11 1/2NPT		0.87	8.19	4.09
40	1 1/2	5.00	3.88	4	0.62	0.63	10.24	5.12	1.89	1.37	8.94	4.47	1 1/2-11 1/2NPT		0.98	8.19	4.09

Nominal Size	mm inch	d	d'	D ₁	D ₂	D ₃	D ₄	C ₁	H	H ₁	H ₂	H ₃	H ₄	H ₅	A	S	S ₁	S ₂	S ₃	e
25	1	0.98	0.87	2.76	1.65	0.98	0.59	1.42	2.68	1.54	1.71	0.24	0.12	0.39	4.33	0.43	0.75	0.29	0.43	0.22
32	1 1/4	1.57	1.34	3.94	2.24	1.38	0.91	1.97	3.50	2.17	2.40	0.39	0.12	0.47	5.16	0.71	1.18	0.35	0.59	0.26
40	1 1/2	1.57	1.34	3.94	2.24	1.38	0.91	1.97	3.50	2.17	2.40	0.39	0.12	0.47	5.16	0.71	1.18	0.35	0.59	0.26



DIAPHRAGM VALVE
BALL VALVE
BUTTERFLY VALVE
SWING CHECK VALVE
BALL CHECK BALL FOOT VALVE
Y-SEDIMENT STRAINER
DIAPHRAGM VALVE PNEUMATIC
GASKETS



Ren-Xin

仁鑫

Tell: +86)020-82228060 Fax: +86)020-82226718

联络人: 丁劲嵩 13922707985

Web: www.ren-xin.com Email: sales@ren-xin.com

COMPACT BALL VALVE 13mm - 80mm(3/8inch - 3inch)

FEATURES

• Features such as compact, light weight and assembly of a reduced number of parts, the COMPACT BALL VALVES can easily be installed in a small space.

NSF Product

NSF("NSF/ANSI STANDARD 61" Drinking Water System Components-Health Effects)Product.

:Compact BALL VALVE (Material:PVC+EPDM)

*Certified products bear an NSF Certification Mark.

MATERIAL AND WORKING TEMPERATURE

Body material	Working Temperature °C (°F)	Max.Working Pressure(at R.T.) MPa(kgf/cm ²)[PSI]	End Connectors	Color
Unplasticized Polyvinyl Chloride(PVC)	0-50(30-120)	1.0{10.2} [150]	Socket End Threaded End	Dark gray
Chlorinated Polyvinyl Chloride(C-PVC)	0-90(30-195)	1.0{10.2} [150]	Socket End Threaded End	Brown or Light gray

Notes : 1. There is a dead space in a ball valve. Volatile liquids, such as a hydrogen peroxide (H₂O₂) and sodium hypochlorite (NaClO) may vaporize in the dead space, thus causing an abnormal pressure increase in the valve. (Important: Gas is compressible. Thus if its pressure rises abnormally, the valve can burst ejecting dangerous fragments.)

WORKING PRESSURE VS. TEMPERATURE

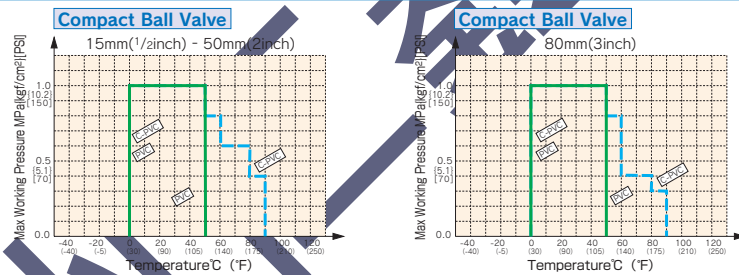

DIMENSIONS TABLE

DIN											Unit:mm	
Nominal Size	d	Socket End			Threaded End			D	H	A		
		d ₁	ℓ	L	DIN 2999							
mm	inch	d ₁	ℓ	L	d ₁	ℓ	L					
13	3/8	13	16	14	85	Rc 3/8	15	85	35	42	60	
15	1/2	15	20	16	97	Rc 1/2	15	97	39	44	70	
20	3/4	20	25	19	102	Rc 3/4	17	102	48	55	80	
25	1	25	32	22	114	Rc 1	20	114	58	60	80	
32	1 1/4	31	40	26	127	Rc 1 1/4	22	127	66	70	95	
40	1 1/2	35	50	31	152	Rc 1 1/2	25	152	72.5	76	110	
50	2	45	63	38	176	Rc 2	28	176	88.5	85	110	
80	3	68.5	90	51	236	Rc 3	35	236	130	124	200	

ANSI											Unit:inch	
Nominal Size	d	Socket End				Threaded End			D	H	A	
		ASTM SCH40				ANSI/ASME B1.20.1						
inch	mm	d ₁	d ₂	ℓ	L	d ₁	ℓ	L				
1/2	13	0.51	0.848	0.836	0.69	3.35	1/2-14NPT	0.59	3.35	1.38	1.65	2.36
3/4	20	0.79	1.058	1.046	0.72	4.02	3/4-14NPT	0.67	4.02	1.89	2.17	3.15
1	25	0.98	1.325	1.310	0.87	4.49	1-11 1/2NPT	0.79	4.49	2.28	2.36	3.15
1 1/4	32	1.22	1.670	1.655	0.94	5.00	1 1/4-11 1/2NPT	0.87	5.00	2.60	2.76	3.74
1 1/2	40	1.38	1.912	1.894	1.09	5.98	1 1/2-11 1/2NPT	0.98	5.98	2.85	2.99	4.33
2	50	1.77	2.387	2.369	1.16	6.93	2-11 1/2NPT	1.10	6.93	3.48	3.31	4.33
3	80	2.70	3.516	3.492	1.87	9.29	3-8NPT	1.17	9.29	5.12	4.88	7.87

PARTS & MATERIALS

No.	DESCRIPTION	Pcs.	MATERIAL
①	BODY	1	PVC, C-PVC
②	BALL	1	PVC, C-PVC
③	END CONNECTOR	1	PVC, C-PVC
④	STEM	1	PVC, C-PVC
⑤	SEAT	2	PTFE
⑥	CUSHION	2	EPDM, FKM
⑦	O-RING	1	EPDM, FKM
⑧	HANDLE	1	ABS
⑨	RING※	2	STAINLESS STEEL304

Note : The ring (⑨) is used for C-PVC valves 13mm ~ 25mm in nominal size.

Tell: +86)020-82228060 Fax: +86)020-82226718

联络人: 丁劲嵩 13922707985

Web: www.ren-xin.com Email: sales@ren-xin.com



LAB COCK

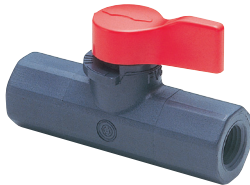

FEATURES

• The LAB COCK is a compact, light weight plastic valve which is highly corrosion-resistant, in durable.

NSF Product

NSF("NSF/ANSI STANDARD 61" Drinking Water System Components-Health Effects)Product.

:LAB COCK(Material:PVC+EPDM)

*Certified products bear an NSF Certification Mark.

MATERIAL AND WORKING TEMPERATURE

Body material	Unplasticized Polyvinyl Chloride(PVC)
Working Temperature	0°C - 50°C (30° F - 120° F)
Max.Working Pressure	1.0MPa{10.2kgf/cm ² }[150PSI]
End Connectors	Hose, Male thread, Female thread
Nominal Size	●Hose:12 to 15mm(standard hose inner diameter) ●Male thread:1/4,1/2 ●Female thread:1/4,3/8

WORKING PRESSURE VS. TEMPERATURE

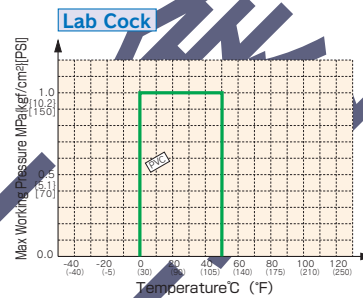

DIMENSION

FEMALE THREAD × FEMALE THREAD

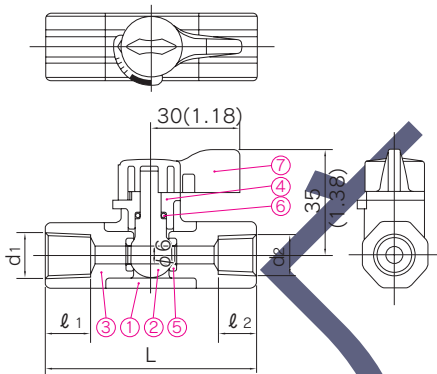

HOSE × HOSE

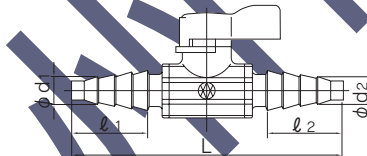

MALE THREAD × HOSE

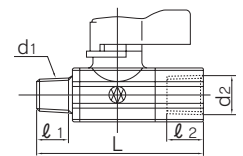
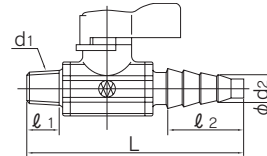

FEMALE THREAD × HOSE

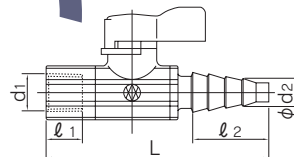

MALE THREAD × MALE THREAD

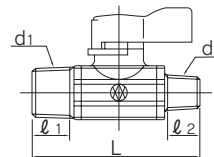

PARTS & MATERIALS

No.	DESCRIPTION	Pcs.	MATERIAL
①	BODY	1	PVC
②	BALL & STEM	1	PVC
③	END CONNECTOR	2	PVC
④	GLAND	1	PVC
⑤	SEAT	2	EPDM, PTFE, others
⑥	O-RING	1	EPDM, others
⑦	HANDLE	1	ABS

DIMENSIONS TABLE

DIN							Unit:mm						
		d ₁	d ₂	ℓ ₁	ℓ ₂	L			d ₁	d ₂	ℓ ₁	ℓ ₂	L
①	FEMALE THREAD × FEMALE THREAD	Rp 1/4	Rp 1/4	15	15	71	④	MALE THREAD × HOSE	R 1/4	10	13	30.5	88.5
		Rp 3/8	Rp 1/4	15	15	71			R 1/2	10	15	30.5	91
		Rp 3/8	Rp 3/8	15	15	71			R 1/4	R 1/4	13	13	66
②	HOSE × HOSE	10	10	30.5	30.5	111	⑤	MALE THREAD × MALE THREAD	R 1/2	R 1/4	15	13	68.5
③	FEMALE THREAD × HOSE	Rp 1/4	10	15	30.5	91			R 1/2	R 1/2	15	15	71
		Rp 3/8	10	15	30.5	91	R 1/4	Rp 1/4	13	15	68.5		
							⑥	MALE THREAD × FEMALE THREAD	R 1/4	Rp 3/8	13	15	68.5
									R 1/2	Rp 1/4	15	15	71
									R 1/2	Rp 3/8	15	15	71
									R 1/2	Rp 3/8	15	15	71

ANSI							Unit:inch						
		d ₁	d ₂	ℓ ₁	ℓ ₂	L			d ₁	d ₂	ℓ ₁	ℓ ₂	L
①	FEMALE THREAD × FEMALE THREAD	1/4-18NPT	1/4-18NPT	0.51	0.51	2.80	④	MALE THREAD × HOSE	1/4-18NPT	0.39	0.51	1.20	3.48
		3/8-18NPT	1/4-18NPT	0.59	0.51	2.80			1/2-14NPT	0.39	0.59	1.20	3.58
		3/8-18NPT	3/8-18NPT	0.59	0.59	2.80			1/4-18NPT	1/4-18NPT	0.51	0.51	2.60
②	HOSE × HOSE	0.39	0.39	1.20	1.20	4.37	⑤	MALE THREAD × MALE THREAD	1/2-14NPT	1/4-18NPT	0.59	0.51	2.70
③	FEMALE THREAD × HOSE	1/4-18NPT	0.39	0.51	1.20	3.58			1/2-14NPT	1/2-14NPT	0.59	0.59	2.80
		3/8-18NPT	0.39	0.59	1.20	3.58	1/4-18NPT	1/4-18NPT	0.51	0.51	2.70		
							⑥	MALE THREAD × FEMALE THREAD	1/4-18NPT	3/8-18NPT	0.51	0.59	2.70
									1/2-14NPT	1/4-18NPT	0.59	0.51	2.80
									1/2-14NPT	3/8-18NPT	0.59	0.59	2.80
							⑦	MALE THREAD × ELBOW	1/2-14NPT	0.63	0.59	1.26	3.66

■ LAB COCK 1/2inch MALE THREAD × ELBOW 16mm



MATERIAL AND WORKING TEMPERATURE

Body material	Unplasticized Polyvinyl Chloride(PVC)
Working Temperature	0°C - 50°C (30° F - 120° F)
Max.Working Pressure	1.0MPa{10.2kgf/cm ² }[150PSI]
End Connectors	R1/2inch Male thread × Elbow 16mm

PARTS & MATERIALS

No.	DESCRIPTION	Pcs.	MATERIAL
①	BODY	1	PVC
②	BALL & STEM	1	PVC
③b	END CONNECTOR	1	PVC
③c	END CONNECTOR	1	PVC
④	GLAND	1	PVC
⑤	SEAT	2	PTFE
⑥	O-RING	1	EPDM, Others
⑦	HANDLE	1	ABS
⑧	ELBOW	1	PVC

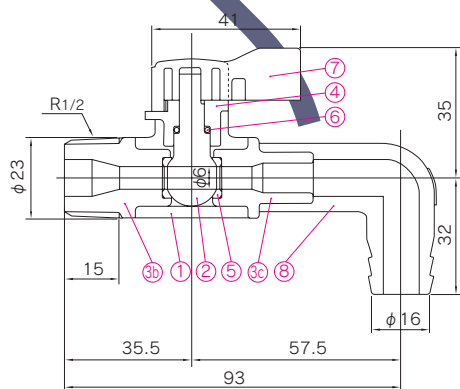

Tell: +86)020-82228060 Fax: +86)020-82226718

联络人: 丁劲嵩 13922707985

Web: www.ren-xin.com Email: sales@ren-xin.com



AV GASKET



Full face Type Rubber Gasket



Ring Type Gasket (JIS only)



PTFE coated



PVDF coated

● MATERIAL : EPDM, PTFE, PVDF, CSM, FKM, IIR, Viton F, C

FEATURES

- AV GASKETS offer Similar sealing performance with 1/3 bolt tightening torque, compared to flat or envelope style gaskets.
- Uniform dimension, fine surface, suitable hardness.
- Long service life.
- Unique Convex Design.

SPECIFICATIONS

Material	Working Temperature	SIZE AVAILABILITY BY STANDARD		
		JIS	ANSI	DIN
EPDM	-40°C - 90°C (-40°F - 195°F)	15mm - 350mm	1/2inch - 16inch *1	15mm - 350mm
PTFE	-40°C - 120°C (-40°F - 250°F)	15mm - 300mm	1/2inch - 12inch	15mm - 300mm
PVDF	-40°C - 120°C (-40°F - 250°F)	15mm - 300mm	1/2inch - 10inch *2	15mm - 300mm
VIFLON	-5°C - 150°C (-5°F - 280°F)	15mm - 200mm	—	—

Working temperature is different depending on type of fluid.

Voflon-F has superior resistance to inorganic acids such as HNO₃, HF and HCl.

Voflon-C has superior resistance to chlorine containing media such as Chlorine Water, NaCl and ClO₂.

*1 14inch, 16inch:FLAT FULL FACE

*2 Except for 1 1/4inch and

DIMENSIONS

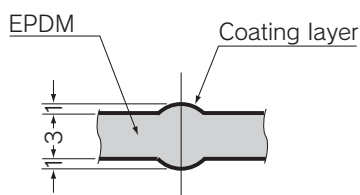
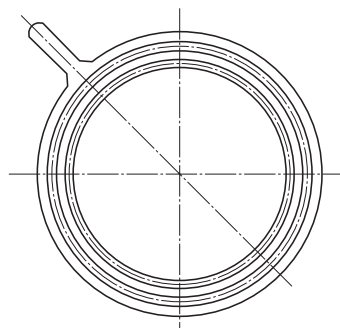
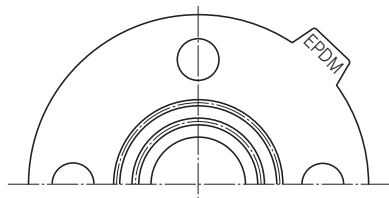
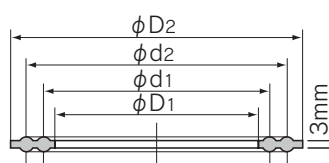
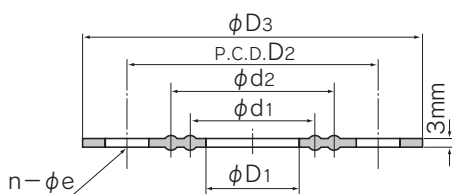

Type	Nominal Size	Thickness
PTFE	15mm(1/2inch) to 300mm(12inch)	0.3-0.4mm(0.012-0.016inch)
PVDF	15mm(1/2inch) to 65mm(2 1/2inch) 80mm(3inch) to 300mm(12inch)	0.4-0.5mm(0.016-0.020inch)

DIMENSIONS TABLE

Full-Face Type (DIN 2501)								Unit:mm
Nominal Size		D ₁	D ₂	D ₃	n	e	d ₁	d ₂
mm	inch							
15	1/2	18	65	93	4	14	26	41
20	3/4	22	75	103	4	14	32	47
25	1	30	85	113	4	14	38	53
32	1 1/4	37	100	138	8	18	50	65
40	1 1/2	43	110	148	4	18	54	69
50	2	54	125	163	4	18	68	83
65	2 1/2	69	145	183	4	18	86	101
80	3	80	160	198	8	18	98	112
100	4	102	180	218	8	18	120	138
125	5	127	210	248	8	18	145	166
150	6	150	240	283	8	23	168	190
200	8	198	295	338	8	23	216	247
250	10	249	350	393	12	23	270	306
300	12	300	400	443	12	23	324	352
350	14	350	460	503	16	25	370	390

Full-Face Type (ANSI CLASS150)								Unit:inch
Nominal Size		D ₁	D ₂	D ₃	n	e	d ₁	d ₂
inch	mm							
1/2	15	0.7	2.4	3.4	4	0.6	1.0	1.6
3/4	20	0.9	2.8	3.8	4	0.6	1.3	1.9
1	25	1.2	3.1	4.2	4	0.6	1.5	2.1
1 1/4	32	1.5	3.5	4.5	4	0.6	2.0	2.6
1 1/2	40	1.7	3.9	4.9	4	0.6	2.1	2.7
2	50	2.1	4.7	5.9	4	0.8	2.7	3.3
2 1/2	65	2.7	5.5	6.9	4	0.8	3.4	4.0
3	80	3.2	6.0	7.4	4	0.8	3.9	4.4
4	100	4.0	7.5	8.9	8	0.8	4.7	5.4
5	125	5.0	8.5	9.9	8	0.9	5.7	6.5
6	150	5.9	9.5	10.9	8	0.9	6.6	7.5
8	200	7.8	11.8	13.4	8	0.9	8.5	9.7
10	250	9.8	14.3	15.9	12	1.0	10.6	12.1
12	300	11.8	17.0	18.9	12	1.0	12.8	13.9
14	350	13.9	18.7	20.9	12	1.14	14.6	15.4
16	400	15.6	21.2	23.4	16	1.14	17.3	18.5

*1 14inch, 16inch:FLAT FULL FACE

RECOMMENDED TIGHTENING TORQUE <ALL MATERIALS / FULL FACE TYPE>

mm(inch)	N·m	FT-LB	mm(inch)	N·m	FT-LB	mm(inch)	N·m	FT-LB
15 (1/2)	17.5	13	65 (2 1/2)	22.5	16	200 (8)	55	40
20 (3/4)	17.5	13	80 (3)	30	22	250(10)	55	40
25 (1)	20	14	100(4)	30	22	300(12)	60	43
40 (1 1/2)	20	14	125(5)	40	29	350(14)	60	43
50 (2)	22.5	16	150(6)	45	32	400(16)	80	58

ASIA VALVE

Abbreviations for Major Materials Used For Asahi AV Products

Symbol	Description
PVC	"PVC" is an abbreviation for "polyvinyl chloride."
C-PVC	The first letter "C" stands for "chlorinated." "C-PVC" refers to "chlorinated polyvinyl chloride," or heat-resistant polyvinyl chloride.
HI-PVC	The first lettering "HI" means "high impact." "HI-PVC" refers to "high impact resist polyvinyl chloride."
PP	"PP" is an abbreviation for "polypropylene."
PVDF	"PVDF" is an abbreviation for "polyvinylidene fluoride."
FRP	"FRP" is an abbreviation for "fiber reinforced plastics."
ABS	"ABS" is an abbreviation for "acrylonitrile butadiene styrene."
PPS	"PPS" is an abbreviation for "polyphenylenesulfide."
PEEK	"PEEK" is an abbreviation for "polyether ether ketone."
PTFE	"PTFE" is an abbreviation for "poly tetra fluoro ethylene."
PDCPD	"PDCPD" is an abbreviation for "polydicyclo pentadiene."
UHMWPE	"UHMWPE" is an abbreviation for "ultra high molecular weight polyethylene."
EPDM	"EPDM" is an abbreviation for "ethylene propylene diene rubber."
FKM	"FKM" is an abbreviation for "fluorocarbon rubber."
Viflon F,C (FKM-F, FKM-C)	"Viflon" is Trade Mark of ASAHI ORGANIC CHEMICALS INDUSTRY CO., LTD. of the Terpolymerization Fluorocarbon Elastomers.
SBR	"SBR" is an abbreviation for "styrene butadiene rubber."
NBR	"NBR" is an abbreviation for "acrylonitrile butadiene rubber."
IIR	"IIR" is an abbreviation for "isobtylen isopren rubber."
CSM	"CSM" is an abbreviation for "chlorosulphonated polyethylene."
PPG	"PPG" is an abbreviation for "Glass Fiber Reinforced Polypropylene."
PC	"PC" is an abbreviation for "Polypropylene."
HP-PVC	The first letter "HP" means "High Purity" "HP-PVC" refers to "high purity polyvinyl chloride."



REN-XIN LOCATIONS

Guangzhou Renxin Mechanical&Electronic
Equipment Co.,Ltd
Guangzhou CHINA
Tel: +86/20-8222806
Fax: +86/20-82226718
E-Mail: jingsong.ding@139.com